

Paramax[®]

Parabolic centrifuge



Centrifuge for chips PV25 to PV60



>> Advantages

- > Continuously working
- > Long service life
- > Highly wear-resistant execution
- > Vibration-proof set-up
- > Optimum degree of dryness achievable
- > Fully automatic and continuous operation
- > Compact design
- > Very low maintenance costs
- > Very service-friendly
- > Economic alternative to the lifting bottom centrifuge

>> Functional principle

The wet, free-flowing chips are fed into the infeed hopper of the centrifuge and fall into the drum. The centrifugal force presses the chips against the drum wall and they move upwards onto the slot sieve.

At this point the coolant is separated from the chips. The dried chips are carried over the edge of the drum and quit the centrifuge downwards through the discharge hopper.

The centrifuged liquid can be returned to the production or pumped back for further treatment.

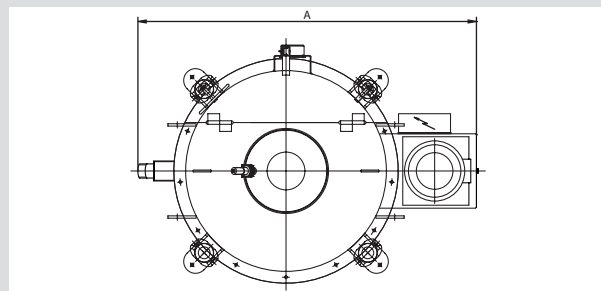
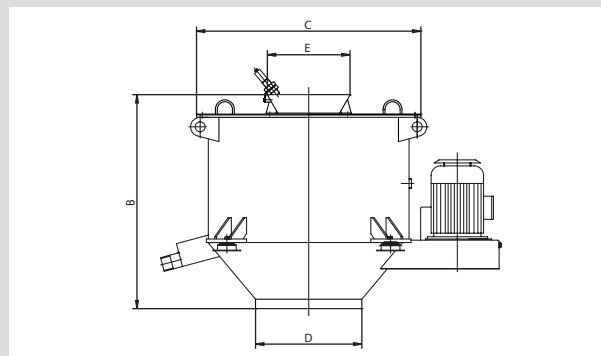

Type	Throughput* [kg/h]			Dimensions [mm]						Capacity [kW]	Weight [kg]
	Steel / Stainless steel	Aluminium	Grey Cast iron	A	B	C Ø	D Ø	E Ø			
PV25	250	80	375	960	530	590	450	250	0,75	120	
PV40	700	230	1.050	1.430	910	950	450	350	2,2	400	
PV50	1.500	460	2.100	1.740	1.120	1.170	550	440	3,5	650	
PV60	2.500	920	4.200	2.080	1.370	1.380	610	510	5,5	850	

* Throughput depending on kind of material and coolant

LANNER[®]
The Specialist for chip processing